

REVOLUTION

M I G R A N G E



CONTROL BOX



POWER SUPPLY 220 V

SYSTEM TORCH CONTROL BOX CONSUMABLES DUTY CYCLE 60%

-	MA1590	BX0412	MEGA 1	140A Mix
DM0020	MA1592	BX0412	PLUS 15	140A Mix

TECHNICAL DATA

Voltage class	L
Cooling	Air cooled
Wire Ø mm	0.6 • 0.8 • 1.0 • 1.2
Voltage supply	24 V DC
Average current	1 A
Main shaft RPM	180
Range wire feeder speed	5 ÷ 14 m/min
Spool size Ø	102 x 45 mm
Spool hole Ø	16 mm

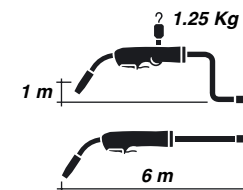

DECLARATION OF CONFORMITY

The undersigned company Trafimet - Via del Lavoro, 8 - 36020 Castegnero (VI) - Italy - declares that the product identified and described on this page complies with standard EN 60974-7 in accordance with the requirements contemplated by directive EEC 73/23 low voltage.



EN 60974-7

trafimet[®]

your welding partner

www.trafimet.com

MEGA 1

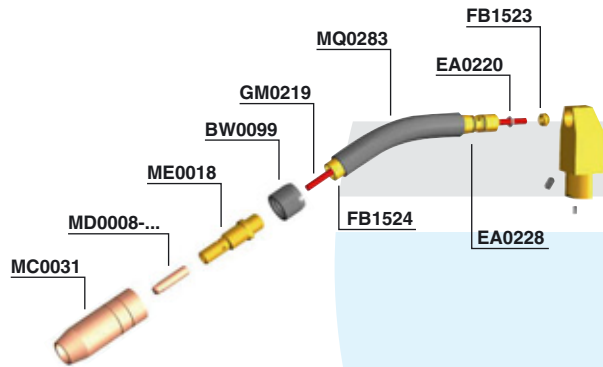

The REVOLUTION MEGA 1 uses the same spare parts as the MEGA 1 torch

PLUS 15

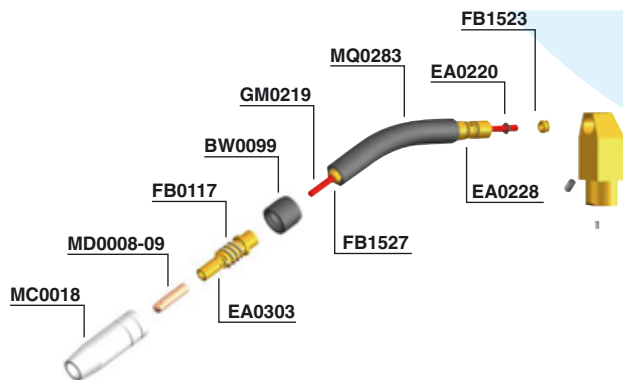

The REVOLUTION PLUS 15 uses the same spare parts as the ERGOPLUS 15 torch

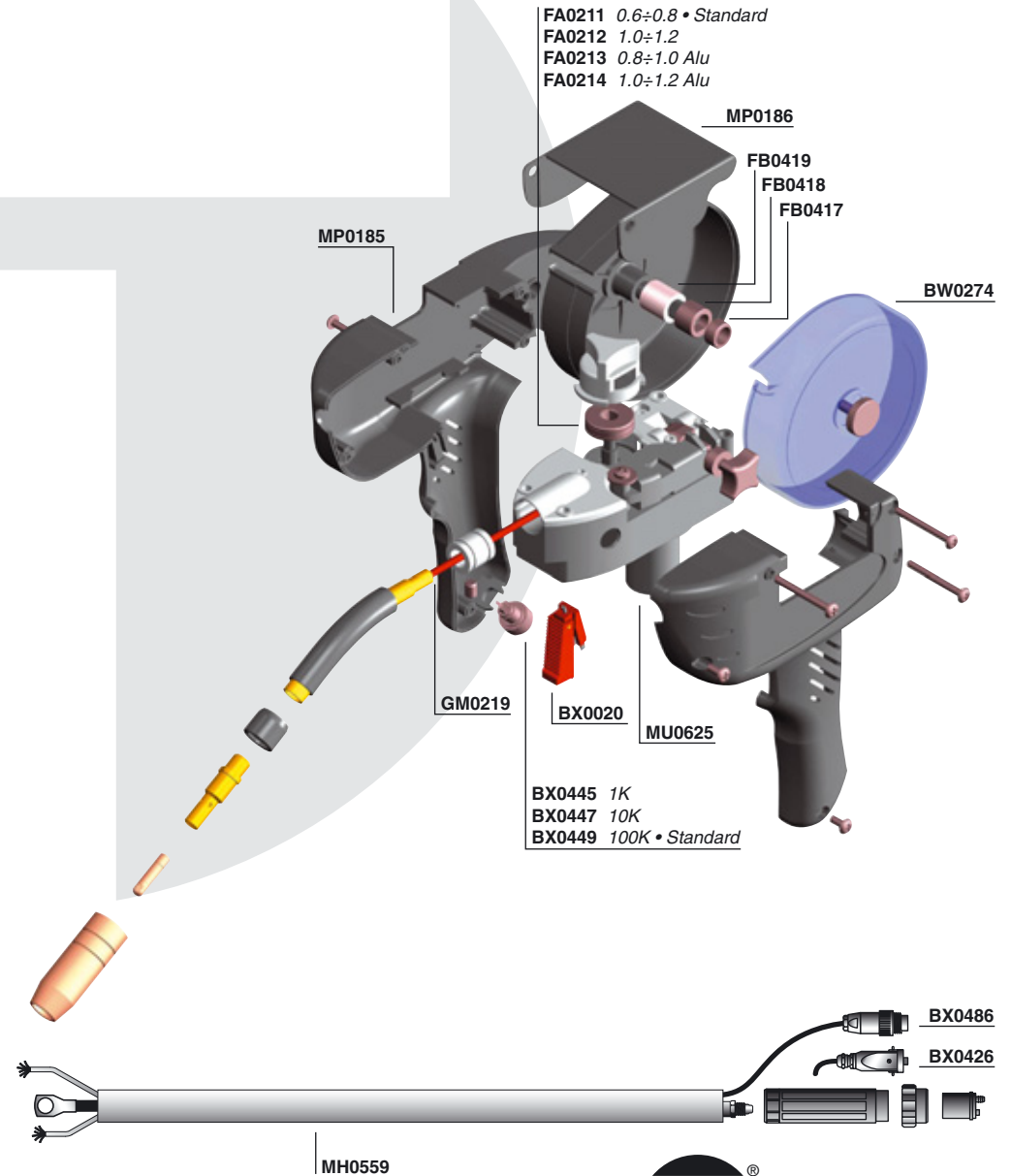

- FA0211 0.6÷0.8 • Standard
- FA0212 1.0÷1.2
- FA0213 0.8÷1.0 Alu
- FA0214 1.0÷1.2 Alu

- BX0445 1K
- BX0447 10K
- BX0449 100K • Standard

